



Garden Seat

Assembly & Mounting Instructions

General Information:

- Read instructions through carefully before beginning assembly.
- Identify each component from material list.
- When assembling components, place on a non-abrasive surface to avoid scratches.
- Do not use excessive force when assembling components.
- In the event of missing or defective parts, please call our customer service department at 1-800-282-9346 (ext.#20).

Materials Included: (In 1 box)

Part #	Description	Quantity
1	2" x 3 1/2" x 43" Seat rails	4
2	2" x 3 1/2" x 43" Back rails	2
3	7/8" x 1 1/2" x 17 3/4" Spindles	13
4	1 1/2" Steel seat brackets	2
5	1 1/2" Steel support legs	2
6	2" x 3 1/2" Rail insert caps	12
7	Hardware kit (Includes):	
	2 1/2" Stainless machine screws	12
	1/4" Stainless lock washers	12
	1 1/4" Self-tapping steel screws	2
	Tube of vinyl cement	1

Tools Required:

- #2 Phillips screwdriver
- Tape measure
- 3/8" socket wrench
- Level
- Shovel

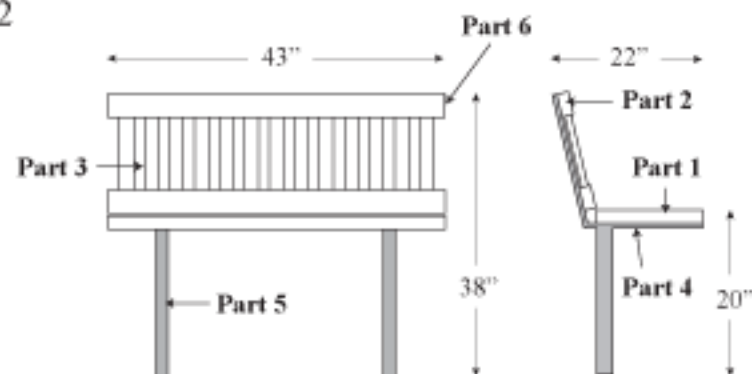

(Fig. 1)
Product dimensions & Part identification.

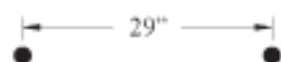

(Fig. 2)
Post layout for installation.

Materials (not included):

- Four bags of pre-mix concrete *

* Required for the proper installation and stability of this product. See step 15 on the inside, for instructions.



1 Take one of the steel seat brackets (part 4). Starting with the side that contains four pilot holes, insert a machine screw with lock washer through the pilot hole closest to the end of the bracket.



2 Line up one end of the seat rail (part 1), and insert the end of the machine screw into the steel coupler insert.

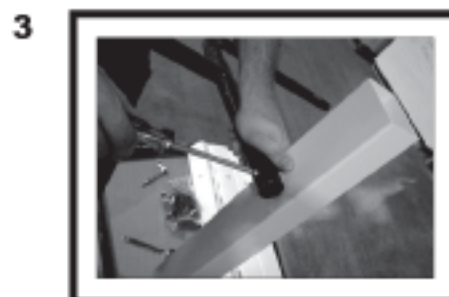

3 Using a Phillips screwdriver, tighten the screw into the coupler until the lock washer and head of the screw are snug against the steel bracket. Repeat steps 1 through 3 for the remaining seat rails.

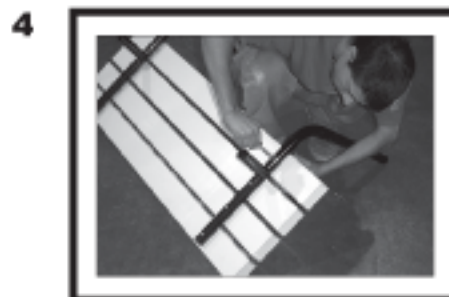

4 Take the second steel seat bracket and secure the opposite end of each rail in place, as shown in steps 1 through 3.

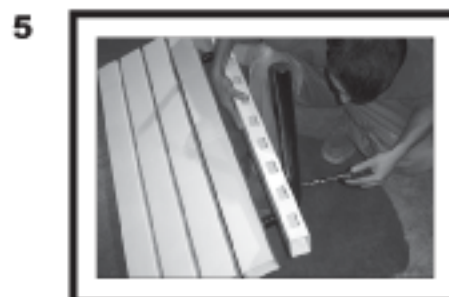

5 Fasten both ends of one of the back rails (part 2) to the steel bracket, using the same method described in steps 2 and 3. Make sure you keep the holes in the rail facing up, as illustrated.



6 Slip one end of each spindle (part 3) into the holes in the back rail, as illustrated.



7 Flip the second back rail upside down and insert the opposite end of each spindle into the holes.



8 Fasten both ends of the second back rail to the steel bracket as in step 5. **Note:** before tightening the screws, make sure the entire seat assembly is square, and that the spindles are straight and parallel to one another.



9 Place the completed seat assembly onto a smooth surface as illustrated. Insert each steel support leg (part 5) into the open ends of the short "stubs" on the underside of each steel bracket.



10 Line up the pilot holes in the support legs and stubs. Using the two self-tapping steel screws provided, fasten each leg in place.



11 Using the vinyl cement provided, apply a bead glue to the inside wall of the rail end.



12 Push the rail insert cap (part 6) firmly into the end of the rail. Hold in place for a couple minutes, to allow the cement to cure. Repeat steps 11 and 12 for the remaining rail ends.



13 Dig two 36" deep holes in the desired location, using the distance shown in (Fig. 2) on the front cover.



14 Set the garden seat into the holes and check the distance from the ground to the top of the seat rails. This should measure approx. 20". At this time, you may need to adjust the depths of the holes.



15 Use a level to check the seat for plumb. Also, check to make sure the spacing between the legs is accurate, and that they are straight and parallel to one another. Once you are satisfied with the orientation, fill in the holes with pre-mix concrete (not included). **Note:** keep the seat supported while the cement sets.

Questions ? :

If you have any questions concerning the assembly or installation of this product and require assistance, please call our **Customer service department at 1-800-282-9346 (ext.#20)**, Weekdays from 8:00 am. to 4:00 pm. Eastern standard time.

If you have any comments or suggestions about our product or service, please let us know! Call: **1-800-282-9346 (ext.#24)**, or E-mail: **info@newenglandarbors.com**

To learn more about us, visit us on the web at: **www.newenglandarbors.com**